

DIMENSIONS: mm (in.)

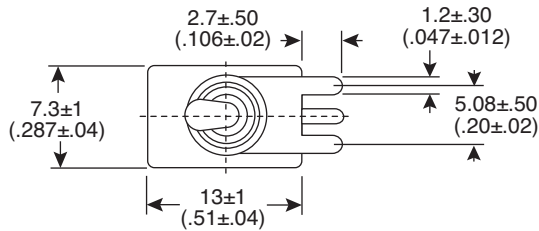

Mounting Hole

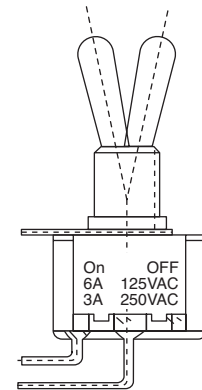
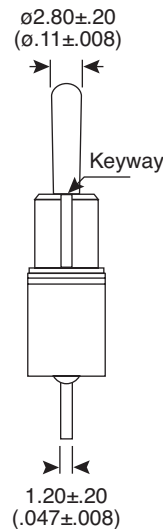
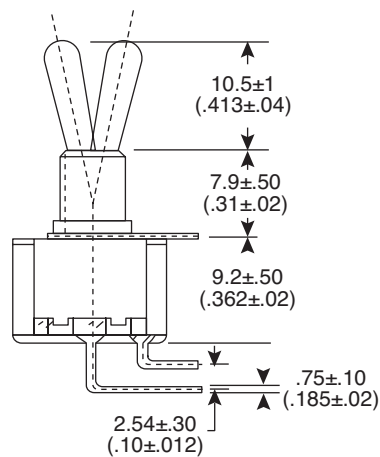
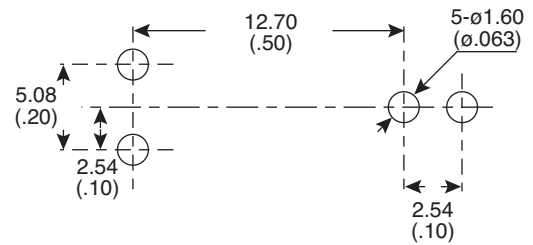

Electrical Specifications:

- Rating: 6A/125VAC, 3A/250VAC
- Contact Resistance: 50mΩ max
- Insulation Resistance: 500VDC 100MΩ min
- Dielectric Strength: 1000VAC for 1 minute

Mechanical Specifications:

- Operating Temperature: -20°C ~ +65°F
- Circuit: 2P SPST On-Off

Note:

- RoHS Compliant by exemption

Miniature Toggle Switch
1055-TA1220B-EVX

